

C2 Remote Control (2.4GHz)

Model No.: C2

Contents

<u>Product Features</u>	2
<u>Product parameters</u>	2
<u>Button Description</u>	3
<u>Link / Unlink</u>	4
<u>Installation Notes</u>	5
<u>Attention</u>	5

1. Product Features

With timing switch, two-way communication, vibration feedback and other functions (MiBoxer series smart switches and smart plugs only), with magnetic wall mount, easy to use 4 groups independently control the on/off of the device.

2. Product parameters

Model No.: C2

Working Voltage: 3V (AAA * 2PCS)

Transmitting Power: 6dBm

Standby Power Consumption: 5 μ A

RF: 2.4GHz

Working Temperature: -10~40°C

Control Distance: 30m

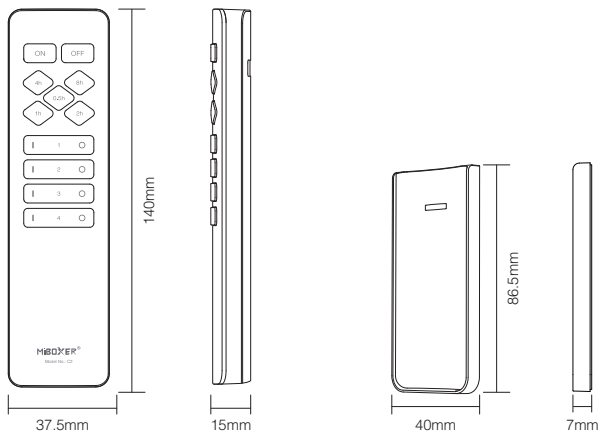

3. Button Description

Time zone (0.5h, 1h, 2h, 4h, 8h)

- (1) Select the group where the device is located.
- (2) Select the required timing time(If the device is on, the scheduled function will turn off the device; otherwise, the scheduled function will turn on the device.)

Attention:

- (1) When the device is in the timing state, Press the "I" or "O" or "ON/OFF" key of the group where the device is located to cancel the current scheduled time.
- (2) "ON / OFF" key can cancel the timing time of all groups.

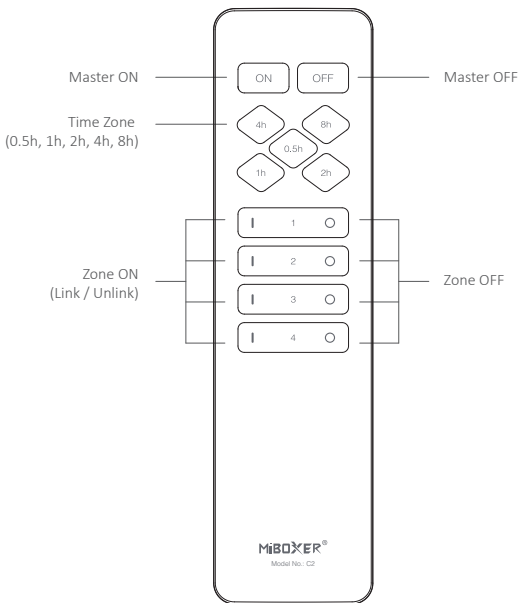

4. Linking/Unlinking

Used with MiBoxer series smart switches or smart sockets, devices can be turned on/off at scheduled times.

Linking instruction

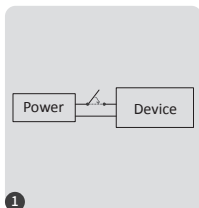

Turn off light after 10 seconds turn off



Short press "I" 3 times within 3 second when the light on

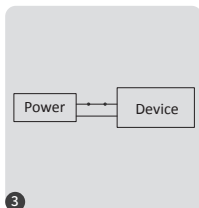

Light flashing 3 times slowly means it is successfully



Linking failed if light is not blinking slowly, Please follow above steps again.
(Note: Light that have linked can't link again)

Unlinking instruction

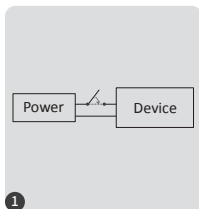

Turn off light after 10 seconds turn on



Short press "I" 5 times within 3 second when the light on

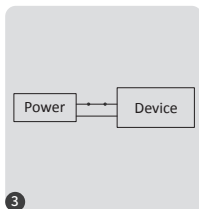

Light flashing 10 times slowly means it is successfully



Unlinking failed if light is not blinking quickly, Please follow above steps again.
(Note: Light haven't linked that don't need to unlink)

5. Installation Notes

1

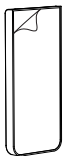

Take off the double-sided tape on the back of the base

2

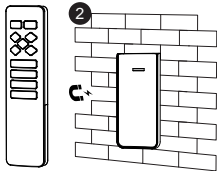

Stick the base well, and the remote control is magnetically attracted to the base

6. Attention

1. This remote only control specified Mi-Light / MiBoxer products; details please check manual.
2. This remote control is a precision electronic product, please do not use it in a humid or high temperature environment for a long time. When not in use for a long time, please take out the battery and store it in a dry, static-free environment.
3. Do not use the remote control in a large area of metal or in an environment with strong electromagnetic waves nearby, otherwise the control distance will be seriously affected.



Made in China