

Casambi Bluetooth + RF 5CH Constant Voltage LED Controller

- DC socket or terminal screw power input, 5-channel constant voltage output, maximum output current per channel is 3A.
- Multi-in-one function for controlling single color, color temperature, RGB, RGBW or RGB+CCT low voltage LED strips.
- Casambi APP control, support on/off, RGB color, color temperature and brightness adjustment, group control, scene editing, minimum/maximum brightness setting, power-on startup status and multiple power-down memory function settings.
- Set up multiple light types via the Casambi APP, can match with single-zone or multi-zone RF remotes with the same light types.
- 10 built-in dynamic modes including jumps and fades for RGB, RGBW or RGB+CCT lighting types.
- Light on/off fade time 0-3s selectable.

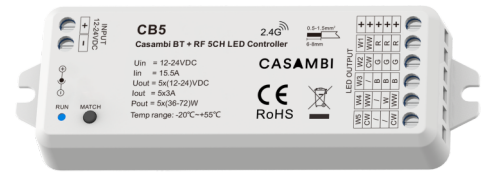

CE RoHS

Technical Parameters





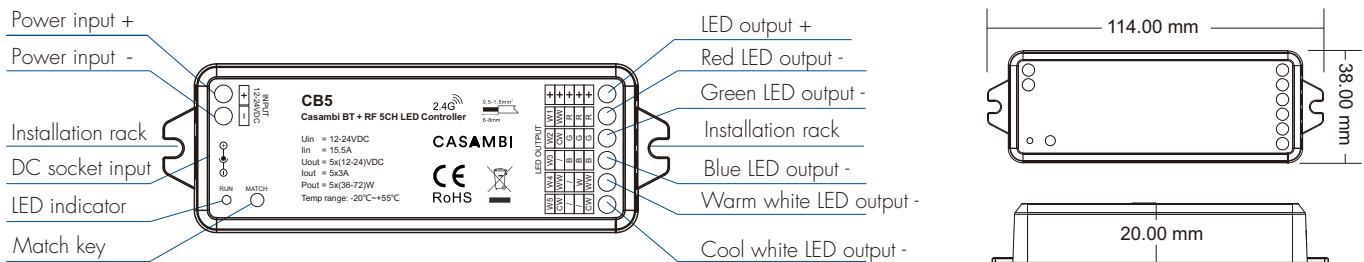





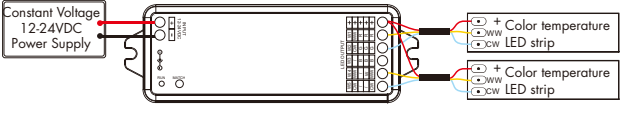

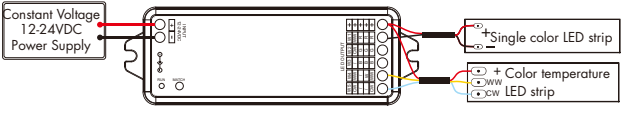

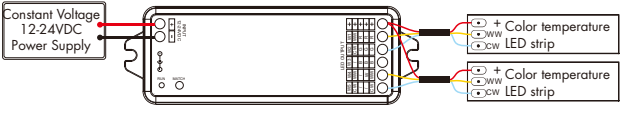
Input and Output		Dimming data		Safety and EMC	
Input voltage	12-24VDC	Input signal	Bluetooth + RF 2.4GHz	EMC standard	EN IEC 55015/EN IEC 61547 ETSI EN 301 489-1/-3/-17
Input current	15.5A	Remote distance	30m(Barrier-free space)	Safety standard	EN 61347-1/-2
Output voltage	5 x (12-24)VDC	Dimming level	4096 (2^12) level	Radio equipment	ETSI EN 300 440 ETSI EN 300 328
Output current	5CH, 3A/CH	Dimming range	0-100%	Certification	CE RoHS
Output power	5 x (36-72)W	Dimming curve	Logarithmic	Warranty and Protection	
Output type	Constant Voltage	PWM Frequency	2000Hz (default)	Warranty	5 years
Package		Environment		Protection	Reverse polarity, Overheat, short circuit
Size	L120 x W43 x H35mm	Operation temperature	Ta: -20°C ~ +55°C		
Gross weight	0.073kg	Case temperature (Max.)	Tc: +85°C		

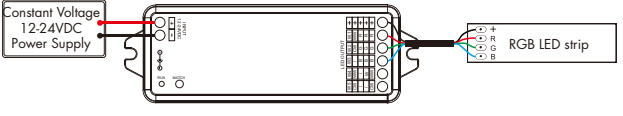
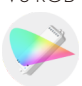
Mechanical Structures and Installations

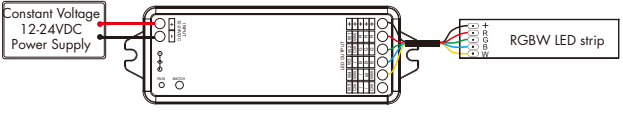

Light Type and Wiring

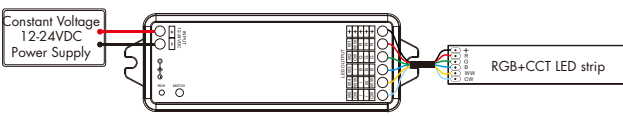
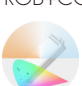
Light type	Model & Profile ID	Application	Wiring diagram
V1-DIM	1CH/Dim 37622	Control 5 single color LED strips synchronously.	
V5-DIMx5	5CH/Dim, Dim, Dim, Dim, Dim 38241	Control 5 single color LED strips independently.	
V2-DIMx2	2CH/Dim, Dim 38232	Control 2 single color LED strips synchronously. Tips: Channels W1~W2 form one group, Channels W3~W4 form one group, Channel W5 no output.	
V4-DIMx4	4CH/Dim, Dim, Dim, Dim 38234	Control 4 single color LED strips independently. Tips: Channel W5 no output.	
V3-DIMx3	3CH/Dim, Dim, Dim 38233	Control 3 single color LED strips synchronously. Tips: Channels W4,W5 no output.	

Light type	Model & Profile ID	Application	Wiring diagram
V2-CCT 	2CH/Dim, TW 37623	Control 2 color temperature LED strips synchronously. Tips: Channel W3 no output.	
V3-DIM+CCT 	3CH/Dim, Dim, TW 38235	Control one single color LED strip and one color temperature LED strip. Tips: Channels W2, W3 no output.	
V4-CCTx2 	4CH/2x[Dim, TW] 38236	Control 2 color temperature LED strips independently. Tips: Channel W3 no output.	
V3-RGB 	3CH/DIM, RGB 37624	Control the RGB LED strip. Tips: Channels W4, W5 no output.	
V3-RGB 	3CH/DIM, X, Y 36123		
V4-RGB+W 	4CH/DIM, RGB/White 38230	Control RGBW LED strip. W white light and RGB color light can be lighted at the same time. Tips: Channel W5 no output.	
V4-RGB+W 	4CH/DIM, XY+W 38244		
V4-RGBW 	4CH/DIM, RGBW 37625		
V4-RGBW 	4CH/DIM, XY+W 38245		
V5-RGB+CCT 	5CH/DIM, RGB, TW 38231	Control RGB+ CCT LED strip. Color temperature light and RGB color light can be lighted at the same time.	
V5-RGB+CCT 	5CH/DIM, XY, TW 37243		
V5-RGBCCT 	5CH/DIM, RGBW, TW 37626		
V5-RGBCCT 	5CH/DIM, XY, TW 38242		

Note:

1. Users can connect a constant voltage power supply or a power adapter as power input.
2. When Casambi APP switches different light types, the color of the LED indicator light is different (DIM: white; CCT: yellow; RGB: red; RGBW: green; RGB+CCT: blue).

Casambi APP Connection

Use Casambi APP for the first time

When devices are used for the first time, they need to be added to the network. A device can only be part of one network. All Casambi devices are normally supplied in an unpaired state.

1. Download the Casambi APP from the Apple App Store or Google Play Store.
2. The device is powered on and automatically enters the config state.
3. The APP will search for all devices with casambi turned on within the Bluetooth range of the mobile device.
4. When a device is added to the network, it can be controlled by application.



Compatible System: Android 4.4 and ios10.0 or above.

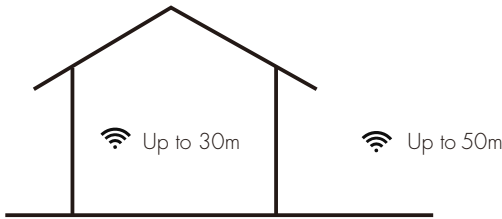

Casambi uses Bluetooth Mesh network technology and each Casambi device can also be used as a repeater for longer distances. The distance is highly dependent on the surroundings and obstacles such as walls and building materials.

Casambi APP user interface

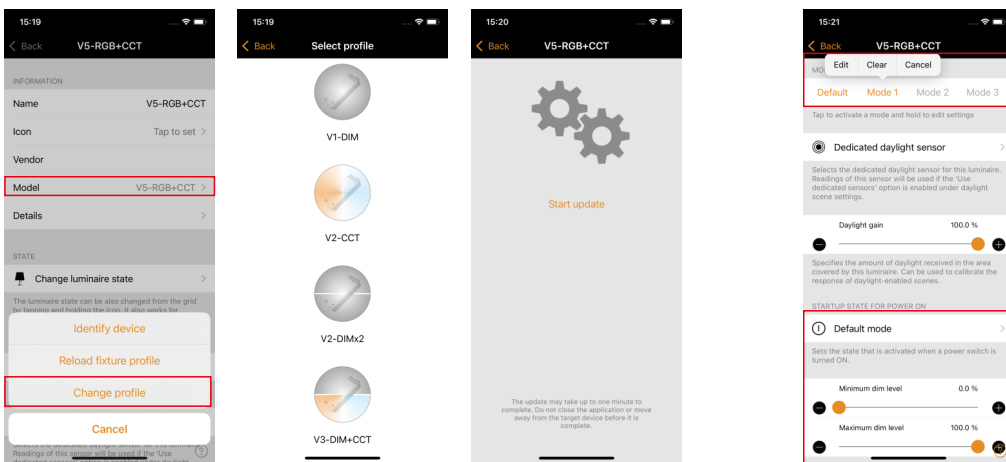

Select the profile:

Double click on the fixture icon, change the profile file through the "Model" in the setting interface, as shown in the figure, you can switch 17 kinds of light type, click "Start Update", the device immediately switch to the corresponding light type.

Mode Settings/Startup Status for Power on

/Minimum, Maximum Brightness Settings:

Setting interface: Long press "Mode 1/2/3" to edit/clear/cancel the setting mode.

Short press "Default Mode" to select power on startup state.

Slide the adjustment bar left/right or touch "+/-" key to set the minimum/maximum brightness.

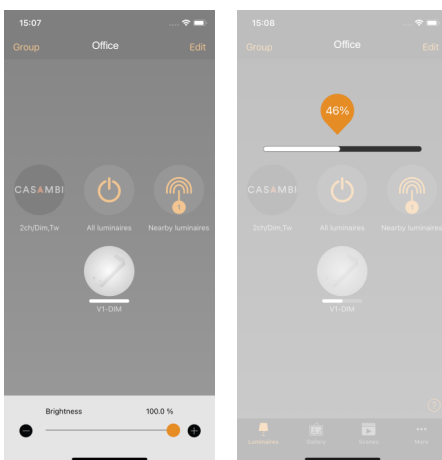

DIM:

Method 1: Slide left and right at the fixture icon to adjust the brightness.

Method 2: Long press the fixture icon, the brightness bar will be displayed at the bottom of the interface, touch the bar to adjust the brightness.

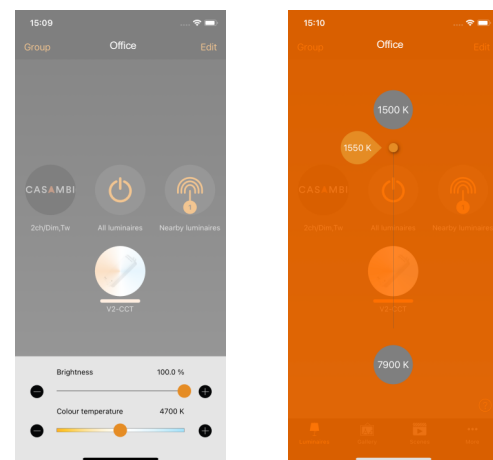

CCT:

Method 1: Slide left and right at the fixture icon to adjust the brightness; slide up and down to adjust the color temperature.

Method 2: Long press the fixture icon, the brightness bar and color temperature bar will be displayed at the bottom of the interface. Touch the brightness bar to adjust the brightness, touch the color temperature bar to adjust the color temperature.

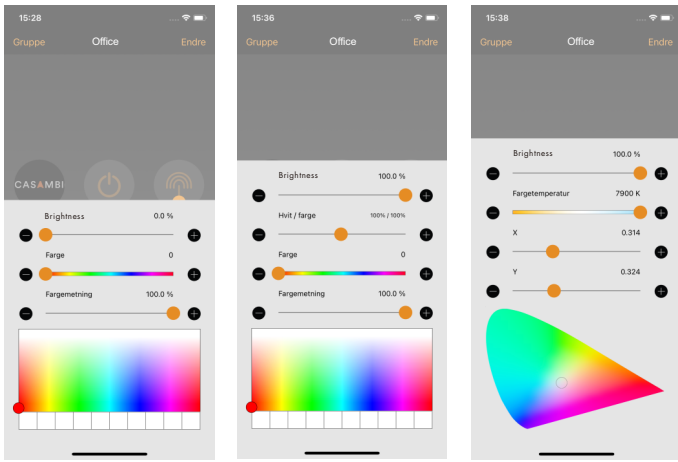

RGB/RGBW/RGB+CCT:

Long press the fixture icon, the slider bar and color selection box will be displayed at the bottom of the interface. Touch the slider and color selection box to adjust the brightness or color of RGB/RGBW/RGB+CCT fixtures.

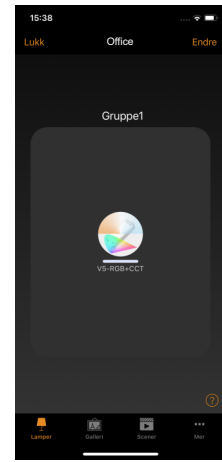
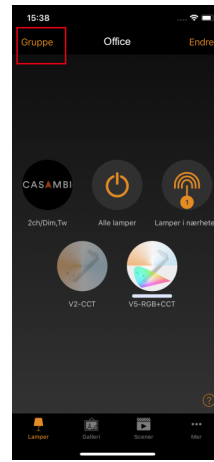

Group Control:

In the main interface, click "Group" in the upper left corner, select the fixture you want to group, and create a group. The main interface shows the new group, and then you can control the group.

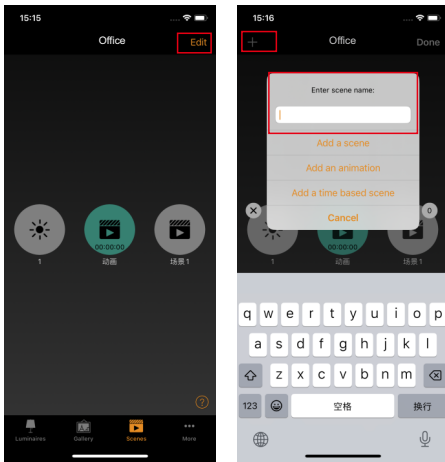

Scene Setting:

Click "Edit" in the upper right corner of the scene interface to add, edit or delete scenes.

Note: All functions of this product can be operated on the APP, so please refer to the Casambi APP User's Guide for details.

Match Remote Control

Please select the RF remote control with the same light type according to the light type set in Casambi APP for match.

Two options are offered for selection:

Use Match key

Match:

Short press match key, immediately press on/off key (single zone remote) or zone key (multiple zone remote) of the remote. The LED indicator fast flash a few times means match is successful.

Delete:

Press and hold match key for 5s to delete all match, The LED indicator fast flash a few times means all matched remotes were deleted.

Use Power Restart(Alternate)

Match:

Switch off the power, then switch on power, repeat again. Immediately short press on/off key (single zone remote) or zone key (multiple zone remote) 3 times on the remote. The light blinks 3 times means match is successful.

Delete:

Switch off the power, then switch on power, repeat again. Immediately short press on/off key (single zone remote) or zone key (multiple zone remote) 5 times on the remote. The light blinks 5 times means all matched remotes were deleted.

Dynamic Mode List (RF remote control call-out only)

Applied to RGB/RGBW:

No.	Name	No.	Name
1	RGB jump	6	RGB fade in and out
2	RGB smooth	7	Red fade in and out
3	6 color jump	8	Green fade in and out
4	6 color smooth	9	Blue fade in and out
5	Yellow cyan purple smooth	10	White fade in and out

Applied to RGB + CCT:

No.	Name	No.	Name
1	RGB jump	6	RGB fade in and out
2	RGB smooth	7	Red fade in and out
3	6 color jump	8	Green fade in and out
4	6 color smooth	9	Blue fade in and out
5	color temperature smooth	10	White fade in and out

Installation Precautions

1. The products shall not be stacked, the distance should be $\geq 20\text{cm}$, so as not to affect lifespan of the products due to poor heat dissipation.
2. The product shall not be installed close to the switching power supply with an interval of $\geq 20\text{cm}$ to avoid radiation interference of the switching power supply.
3. The installation height shall be $\geq 1\text{m}$ from the floor to avoid shortening the remote control distance due to too weak reception signal.
4. The products are not allowed to be close to or covered by metal objects, with an interval of $\geq 20\text{cm}$ to avoid signal attenuation and shorten the remotedistance.
5. Avoid installation at the corner of the wall or the corner of the beam, with an interval of $\geq 20\text{cm}$ to avoid signal interference.